

IMPACT Plus

So much more than just an
interactive touchscreen

Designed by teachers, for teachers, IMPACT Plus is more than just an interactive touchscreen, it delivers a truly intuitive and collaborative experience. Feature-rich, with solutions that free teachers from the constraints of the restrictive traditional classroom. Make lessons extraordinary with the new IMPACT Plus.

Available in a range of sizes
55" | 65" | 75" | 86"

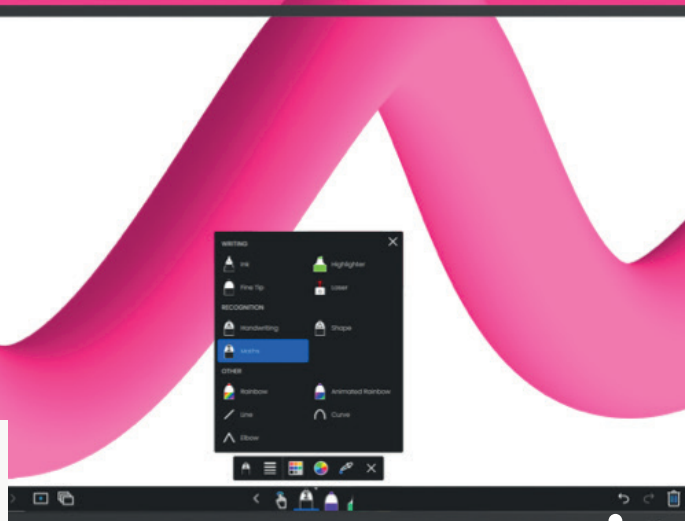

● **Motion Detection**
Environmentally friendly motion detection. Equipped with Proximity Sensors your IMPACT plus will power off when no one is detected in the room.

Software included at no extra cost

CLEVER® LIVE

CLEVERSHARE®

CLEVERMDM®

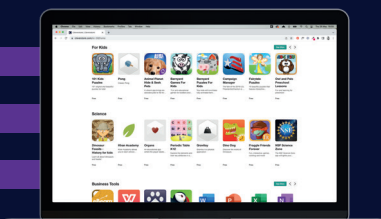

CLEVERSTORE®

Choose from hundreds of apps at no extra cost. Cleverstore has apps in multiple languages and for all age groups and subjects. No adverts, no in-app purchases, no hassle.

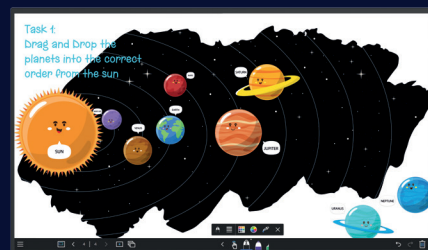

LYNX
whiteboard

LYNX Whiteboard is a free-to-use lesson building app, enabling student collaboration. The most dynamic, intuitive user experience of any whiteboard

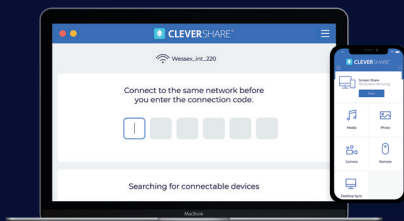

Any device can download the Clevershare app and connect instantly by typing in the code on the Clevertouch screen. Clevershare App is free to download and compatible with Android, Windows, iOS, and Chrome devices.

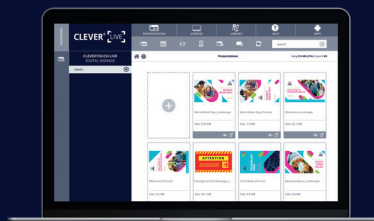

CleverLive controls all of your Clevertouch products from one central place. It is the software platform that enables the creation, deployment and management of content deployed across one or multiple displays. CleverLive is a cloud management platform and is compatible with any device.

Add an Intelligent Sensor to keep track of air quality, light, temperature and humidity.



Key Features



Zero bonding - no air gap gives greater accuracy, improved performance and vibrant imagery



Android 11 4K Chipset – 6GB RAM / 64GB ROM



Front-mounted latest-generation USB-C – allows switching between any device



Front-facing speakers and subwoofer for clearer, more powerful quality audio



Upgraded 6 array microphone



Ambient light sensor



Front-mounted power button



Front-mounted USB-A port



Connect your Cloud accounts to work from anywhere



High precision technology allows writing to be as smooth as writing on a whiteboard – with no lag



Data can be wiped at the end of a session and the screen can be locked with a secure passcode.



True 4K resolution and sharper user experience throughout.

IMPACT Plus Specifications

Display

Diagonal Size	55" 4K, 65" 4K, 75" 4K, 86" 4K
Screen Type	TFT LCD - Direct LED Backlight
Aspect Ratio	16:9
Display Colours	1.07 Billion (10 bit)
Resolution	4K UHD (3840x2160 @60Hz)
Response Time	5ms
Refresh Rate	60Hz
LCD Viewing Angle	178°
Brightness	400 cd/m2
Contrast Ratio	4500:1
Dynamic Contrast Ratio	5000:1
Glass Hardness	AG Tempered Glass - Mohs Level 7
Glass Type	Low Parallax Zero Bonding - Heat tempered - Anti Glare - Super Glide Surface - 4mm
Main Board	9950 MTK (MStar)
Life of Screen	50,000 Hours
NTSC	55", 65", 75" 72% 86" 68%

Interactivity

Writing Technology	High Precision IR Technology
Continuous Touch Points	20
Touch Resolution	32768x32768px
Response Time	≤5ms
Touch Accuracy	1mm
Minimum Object Size	3mm
Touch Tool	Finger, gesture, passive infrared pen
Simultaneous Writing	Yes
Ink In Tools	Yes - Lynx
Pens Included	2
Pen Type	Dual Recognition Stylus
Pen Holder	Integrated full-length pen tray
Pen Tip Diameter	3mm/7mm
Pen & Touch Differentiation	Yes
Pen Identities	2
Palm Rejection	Yes
Annotation Over Any Source	Yes
Classroom Essential Apps	Includes Whiteboard, Annotate, Timer, Media Players, Browser, PDF Reader, Screen Record, Spinner, Voting, Maths Tools
Compatibility*	Windows 10, Linux, Mac, Android, Chrome
Tracking Rate	6m/s
Scan Rate	200Hz
Gestures & Edge Swipes	Windows supported, OSX with additional driver

Connectivity

OPS Slot	1 - Intel Spec 80Pin
HDMI In	3
HDMI Out	Using a USB adapter included in the accessory box
USB-A 2.0	1 (1 USB for system upgrade)
USB Touch (type B)	2
USB A 3.0 (faster data transfer)	4
USB C	1x USB-C with video, audio, touch, power and hardware optimisation and ethernet – front-mounted (Supports 65W Charging) 1x USB-C with video, audio, touch and hardware optimisation – side-mounted
LAN In (RJ45)	1
LAN Out (RJ45)	1
RS-232	Yes
Wake-on-Lan	Yes
Wireless Adapter 2.0 + WAP	Yes
Bluetooth	Yes 5.0
VGA In	1
Audio In	1 (3.5mm)
Optical Out	1 (Coax)
Headphone	1 (3.5mm)
Total touch out ports	2
NFC Reader / Writer	Optional Extra
Camera	Optional Extra
Proximity Sensor	Yes
WiFi	IEEE 802.11a/b/g/n/ac with 2 × 2 MIMO (hotspot only) (both 2.4 and 5 GHz bands)
WiFi Speed	Capable of speeds up to 433Mbps

Computing

Operating System	Android 11
System Version	LUX 11
RAM	6GB
Internal Storage	64GB
CPU	Quad Core A73
GPU	Mali G52MC2
Android Resolution	4K
Integrated LUX UI	Yes
System Architecture	64-bit

Power

Power Requirements	100 - 240 ~ 50/60Hz 3.5A
Power Consumption (Normal)	55" 102 W 65" 117 W 75" 145 W 86" 168 W
Power Consumption (Standby)	< 0.5 Watts
Ultra Quiet Fanless Design	Yes

IMPACT Plus Specifications

Audio

Dual Front Facing, Bass Enhanced Speakers	2 x 15 Watt Speakers + 15 Watt Subwoofer
Audio Out	Yes
SPDIF / Fibre	Yes
Sound Channel	2.1
Line Array Microphone 6 (noise cancelling)	Yes – Omni-directional up to 8 meters
Super Wide Sound	Yes

Operating & Storage Environment

Operating Temperature	0° to 40°
Storage Temperature	-20° to 60°
Operating Humidity	10% to 90% RH
Storage Humidity	10% to 90% RH
Altitude	Below 5000 metres

Physical Spec

Panel Dimensions	55" 1262 x 794 x 89mm 65" 1488 x 920 x 90mm 75" 1709 x 1043 x 89mm 86" 1957 x 1182 x 86mm
Packed Dimensions	55" 1428 x 220 x 902mm 65" 1628 x 208 x 1024mm 75" 1860 x 280 x 1163mm 86" 2112 x 280 x 1304mm
Net Weight	55" 27.7kg 65" 37.3kg 75" 51.1kg 86" 63.8kg
Packed Weight	55" 33.9kg 65" 45.7kg 75" 63.9kg 86" 78.9kg
VESA Mount Point	55" 400 x 200mm 65" 400 x 200mm 75" 800 x 400mm 86" 800 x 600mm

Inside your Clevertouch Box

What's In The Box	(1) Clevertouch IMPACT Plus (1) 1.5M Length HDMI Cable (1) 3M Length USB cable (A-B) (1) 1.5M USBC Cable (1) 3M Regional Power Cable (1) Remote Control (2) Batteries for Remote Control (2) Dual Recognition Stylus (1) User Guide (1) Quick Install Guide (1) Clevertouch WiFi Module
-------------------	---

IMPACT Plus Built-In Features

LYNX™ App With Online Lesson Planning	Yes - LYNX Whiteboard is the default whiteboarding app
Cleverstore™ App Store For Education	Yes
Embedded Digital Signage	Yes
Clevershare™ Mirroring Any Device To The Board	Free for the life of the screen (touch back)
Integrated Personalised Accounts Profiles	Yes
Cloud Account Access	OneDrive, Google Drive
Embedded Room Booking	Yes
Whiteboard Annotation	Yes
Email Out Direct From Touchscreen	Yes
Scan QR Code For Saving Work	Yes
CleverMessage™ - Instant Alert Messaging	Yes
Over-the-Air Updates	Yes
Remote Management Of Touchscreens (MDM)	Yes - One year license

Warranty

Warranty term and upgrade options vary by region. Contact your local reseller or distributor for information and visit clevertouch.com/about/warranty
--

Compliance & Certification

Regulatory Certification	CE, FCC, UL, Energy Star & EEC
--------------------------	--------------------------------



Support

For all Clevertouch products, visit: support.clevertouch.com
--

Statement

Size and weight vary by configuration and manufacturing process, please refer to the actual product. The product images are for illustrative purposes only and may slightly differ in appearance, colour, size, etc. from the actual product. The description, illustrations, etc. in this document may subject to change in accordance with the latest product specification and performance. Should the above-mentioned change in the document become necessary, the document may be updated without written notice.

© 2021 Clevertouch. All rights reserved. Sahara Presentations Systems PLC. is part of the Boxlight group of companies, and the owner of trademarks in several global jurisdictions including but not limited to Clevertouch, the Clevertouch logo, UX Pro, IMPACT™, IMPACT Plus™, Impact MAX, CleverLive, LUX, Lynx, CleverMessage, Cleverstore and Clevershare. All third-party trademarks (including logos and icons) referenced by Clevertouch remain the property of their respective owners. Unless specifically identified as such, Clevertouch's use of third-party trademarks does not indicate any relationship, sponsorship, or endorsement between Clevertouch and the owners of these trademarks. Applicable Terms and Conditions for warranty and support available at clevertouch.com/about/warranty. All weights and dimensions are approximate. Product specifications are subject to change without notice. Clevertouch.com.